

| N | M | L | K | J | H | G | F | E | D | C | B | A | 極数 / Number of contacts |
|-------|-------|-------|-------|-------|-------|-------|-------|-------|---|------|-------|-------|-------------------------|
| 13.75 | 10.15 | 11.15 | 8.15 | 3.625 | 3.375 | 9.15 | 8.35 | 7.25 | 6 | 7 | 8.95 | 10.65 | 30 |
| 16.25 | 12.65 | 13.65 | 10.65 | 4.875 | 4.625 | 11.65 | 10.85 | 9.75 | 6 | 9.5 | 11.45 | 13.15 | 40 |
| 19.25 | 15.65 | 16.65 | 13.65 | 6.375 | 6.125 | 14.65 | 13.85 | 12.75 | 6 | 12.5 | 14.45 | 16.15 | 52 |

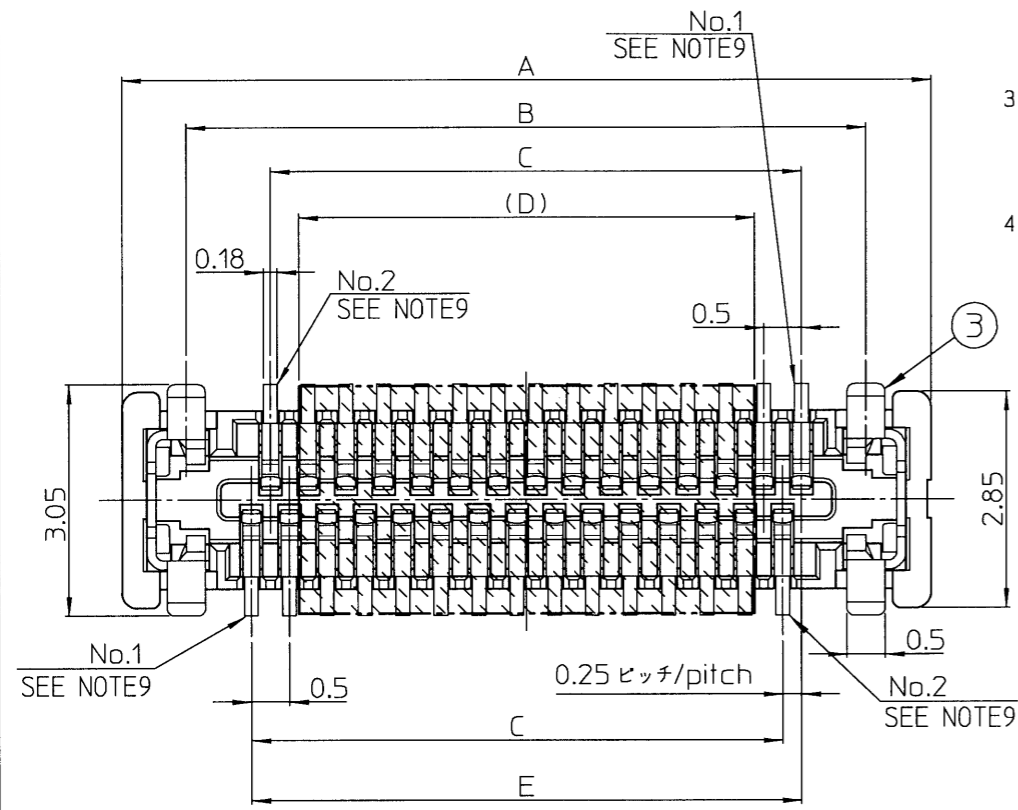

- NOTES
- 1) 指定なき公差
Unless otherwise specified, tolerance shall be:
0~10未満 / Less than 10 ±0.20
10以上 / 10 or more ±0.25
 - 2) コンタクト仕上 / Contact finish.
ニッケルめっき下地 / Under plating Nickel
接合部 / 金めっき
Contact area / Gold plating (0.05~0.25μm)
テール部 / 金めっき
Tail area / Gold plating (0.03~0.25μm)
 - 3) 固定金具仕上 / SMT Retention clip finish.
ニッケルめっき下地 / Under plating Nickel
接合部 / 金めっき
Contact area / Gold plating (0.05~0.25μm)
テール部 / 金めっき
Tail area / Gold plating (0.03~0.25μm)
 - 4) 品名 / Part number
XLSL 00 - 00 - 0
- 梱包数(エンボステープ)
Package quantity per reel(embossed tape)
A: 500 個/リール pcs./reel (30極, 40極に適用/ Applied to 30 and 40 pins)
B: 3000 個/リール pcs./reel (30極, 40極に適用/ Applied to 30 and 40 pins)
C: 5000 個/リール pcs./reel (30極, 40極に適用/ Applied to 30 and 40 pins)
- 極数 / Number of contacts
30: 30 pins, 40: 40 pins
52: 52 pins
- 品種 / Variation
00: レセプタクル SMTタイプ 吸着テープ有り
Receptacle SMT Type With suction tape
01: レセプタクル SMTタイプ 吸着テープ無し(30極, 40極に適用)
Receptacle SMT Type Without suction tape (Applied to 30 and 40 pins)
- シリーズ名 / Series name
XLSL シリーズ/series
- 5) 本図は30極で記載されたものである。
This drawing is based 30 pin contacts.
6) 形状、仕様を変更する場合がございます。治具等を作成する場合には弊社営業へ確認をお願い致します。
Preliminary drawing.
Specification may be changed without prior notice.
7) 推奨メタルマスク厚さ 100μm~150μm
Recommendation metal mask thickness 100μm~150μm

B) 参考基板設計要領 (コネクタ搭載面)
Reference drawing of PWB(Connect mounting side)

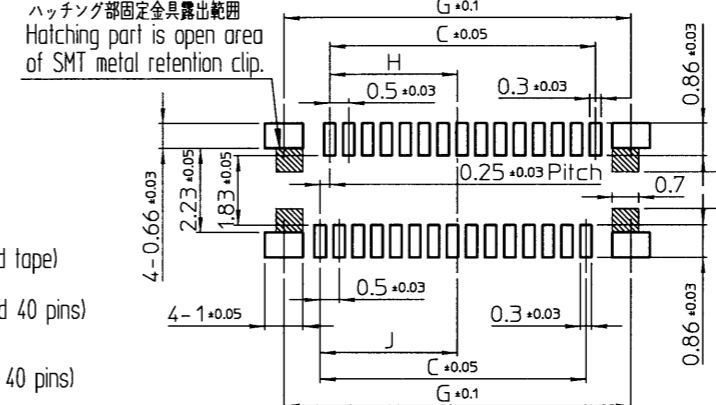

参考基板設計要領 (コネクタ搭載面) (5:1)
Reference drawing of PWB(Connect mounting side)

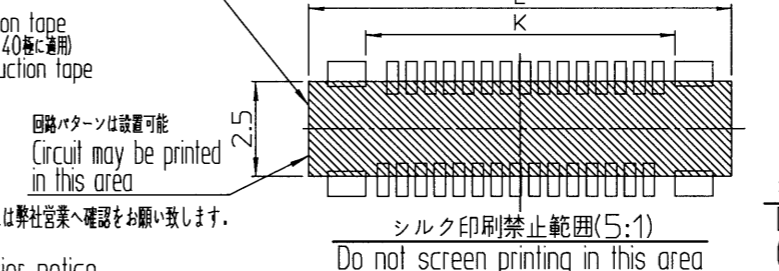

XLSL専用抜去治具を使用の場合はハッチング部には部品を設置しないで下さい。治具が干渉し、使用出来ません。
When using the Extraction tool of XLSL connector, Parts Installation is prohibited at the Hatching area.

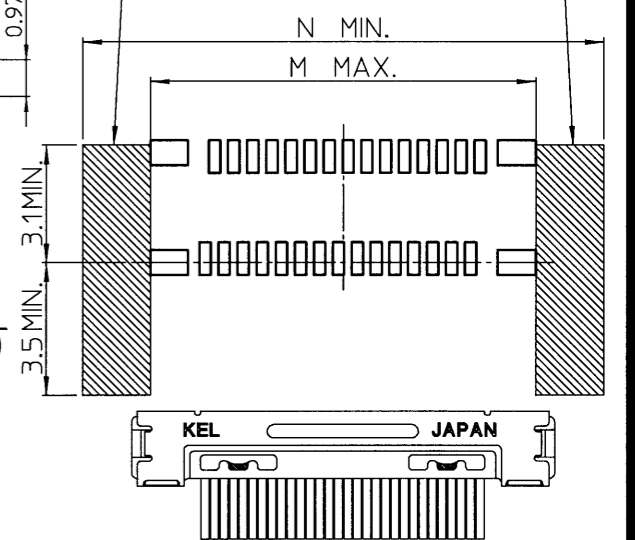

抜去治具使用時の部品設置禁止範囲(嵌合方向ケーブル下引き出しの場合)(5:1)
Do not parts installation in this area, when using the Extraction tool. (Mating direction with cable on lower side)

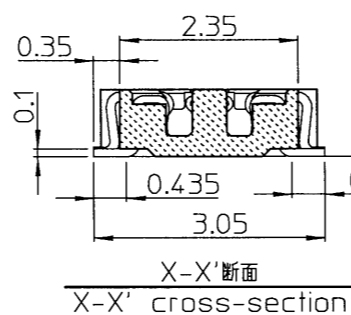
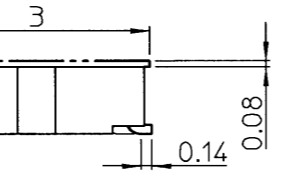
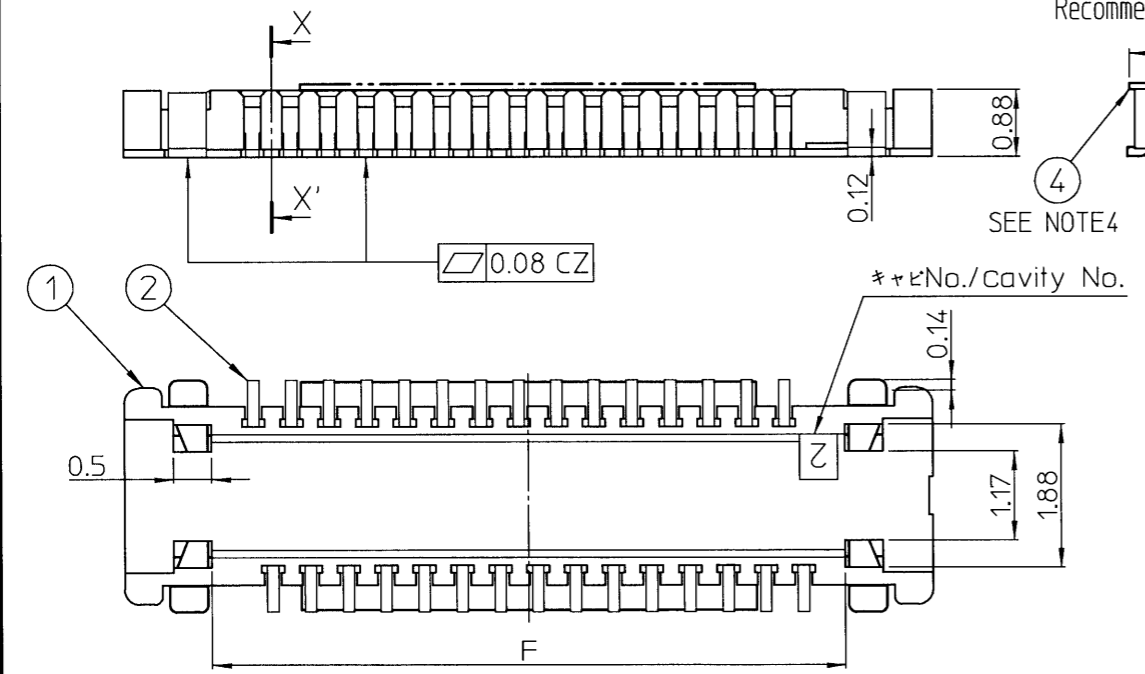

9) 本コネクタは回転対称形状であり実装、嵌合の方向性はありません。
ピン配列、およびプラグコネクタ挿入時の嵌合方向に注意をお願いします。プラグコネクタ挿入方向によるピン配列(コネクタ搭載面)
There is no specific direction for mounting or mating due to that the connector is in rotational symmetric shape.
Please pay attention to pin assignment and mating direction of the plug connector.
Refer to the below figure for the pin assignment (connector installation side) by mating directions of the plug connector.

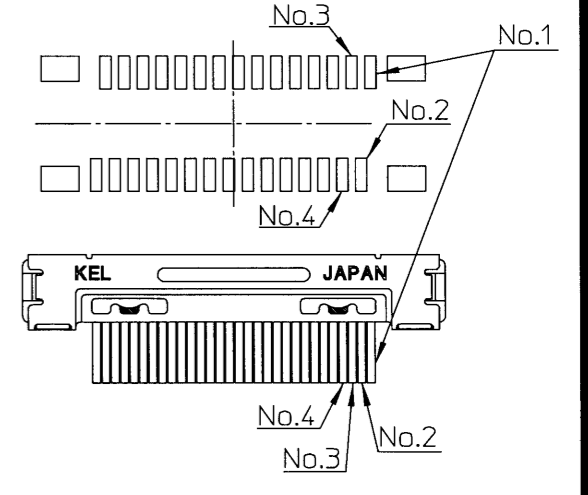
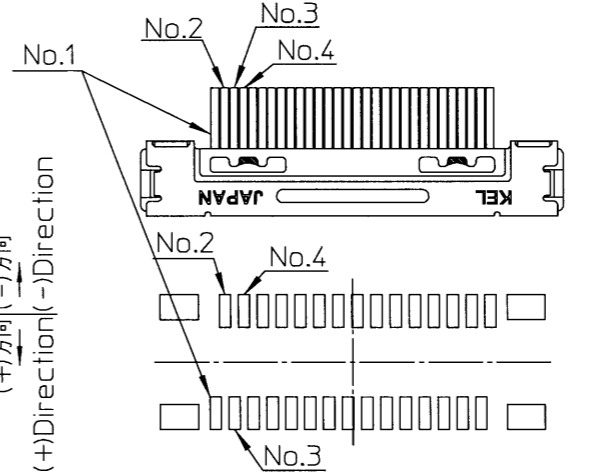

嵌合方向ケーブル上引き出しの場合(5:1) Mating direction with cable on upper side.
嵌合方向ケーブル下引き出しの場合(5:1) Mating direction with cable on lower side.

| | | | | |
|-----|----------------------------|--------------------------|--|--------------|
| ④ | 吸着テープ Suction tape | 1 | ポリイミド Polyimide | |
| ③ | 固定金具 SMT Retention clip | 2 | 銅合金 Copper alloy | SEE NOTE3 |
| ② | コンタクト contact | 極数 Number of contacts | 銅合金 Copper alloy | SEE NOTE2 |
| ① | インシュレータ Insulator | 1 | L.C.P.(UL94V-0)黒 ガラス繊維入 Glass-filled L.C.P.(UL94V-0)Black | |
| No. | 名称 Component | 数量 Quantity | 材質 Material | 仕上 Finish |

| | | | | | | | | | | | | | |
|------------------------|-------------------------|---------------------|------------------------|--|--------------------------|---------------------|---------------|------------|--|--|--------------------|--|--|
| △ x | | | | | | | | | | | | | |
| Oct.13,2020 | n. Sugita | S.Takao | D.Yamshita | 抜去治具使用時の基板設計要領追加(SEE NOTE8) Added Reference drawing of PWB,when using the Extraction tool.(SEE NOTE8) | | | | | | | | | |
| REV. DATE | APPROVED BY | CHECKED BY | DRAWN BY | DESCRIPTION | | | | | | | | | |
| THIRD ANGLE PROJECTION | DRAWN BY S.Mochizuki | DATE May,18,2010 | CHECKED BY N.Sugita | DATE May,18,2010 | APPROVED BY A.Shimada | DATE May,18,2010 | SCALE 10:1 | UNIT mm | | | | | |
| MATERIAL | TITLE | | | | | | | | | | | | |
| FINISH | XLSL00-00-0 | | | | | | | | | | | | |
| | | | | | | | | | | | KEL CORPORATION | | |
| | | | | | | | | | | | DRAWING No. P3C164 | | |
| | | | | | | | | | | | REVISION 4 | | |